

**SIDE RISERS**

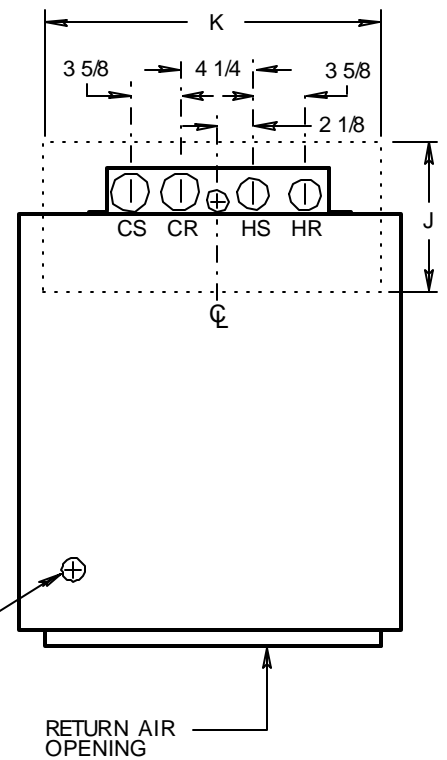

**REAR RISERS**

**Notes:**

1. "Riser size" refers to the larger of the supply and return risers on each unit.
2. Risers are protected by a steel riser cover extending the height of the cabinet. Risers are clamped to help prevent movement during shipment and jobsite handling.

RISER SIZE	MINIMUM J	MINIMUM K
3/4	6	16
1	6	16
1 1/4	6	16
1 1/2	6	16
2	6	16
2 1/2	8	17

All dimensions in inches.

VERTICAL FAN COIL UNITS

**THE WHALEN COMPANY**  
EASTON, MARYLAND

**RISER DETAILS**  
4 PIPE UNITS WITH  
INTERNAL DRAIN PAN

DRAWING NUMBER 409B-PT

JANUARY 1998